

**FOR TRI-TECH MODEL NUMBERS:**

Style Outlet	Nitrous Oxide	Carbon Dioxide	Nitrogen	Medical Air	Medical Vacuum	Oxygen	WAGD	Instrument Air
Allied	XAXX04	XAXX08	-	XAXX16	XAXX22	XAXX24	XAXX32	-
DISS	XFXX04	XFXX08	XFXX12	XFXX16	XFXX22	XFXX24A	XFXX32	XFXX2080
Ohmeda	XQXX04	XQXX08	-	XQXX16	XQXX22	XQXX24	XQXX32	-
Puritan	XPXX04	-	-	XPXX16	XPXX22	XPXX24	XPXX32	-

Back Bodies	90 deg Tube	180 deg Tube	90 deg Barb	180 deg Barb	90 deg DISS	180 deg DISS
Recessed	XX11XX	XX12XX	-	-	-	-
Surgical Arm/Console	XX57XX XX67XX	XX56XX XX66XX	XX51XX XX61XX	XX52XX XX62XX	XX53XX XX63XX	XX54XX XX64XX
Surface	XX21XX	-	-	-	-	-

**Note:** -A means that it can be Front Body or Back Body Assembly. -MRI means that this is for MRI (*Magnetic Resonance Imaging*) units. The "S" in front of the part number means that is a Special or Specific for that customer. The "ALN" in front of the part number is a for a Brushed Aluminum Finish. The "ASN" in front of the part number is for Solid Color Finish. The "DPN" in front of the part number is for outlets with a Pewter Die Cast trim plate. The "NSI" is for ISO Color and the "NSN" is for NFPA Color Code no specific customer. The "TDN" is for Dental Gas Outlets and "TLN" is for Laboratory Gas Outlets

**General Note:** Please request for the proper Submittal Data Sheets on any specific outlet.

**Outlet Installation**

Figure 1

Oxygen Outlet Shown

Installation is typical for all gas services.

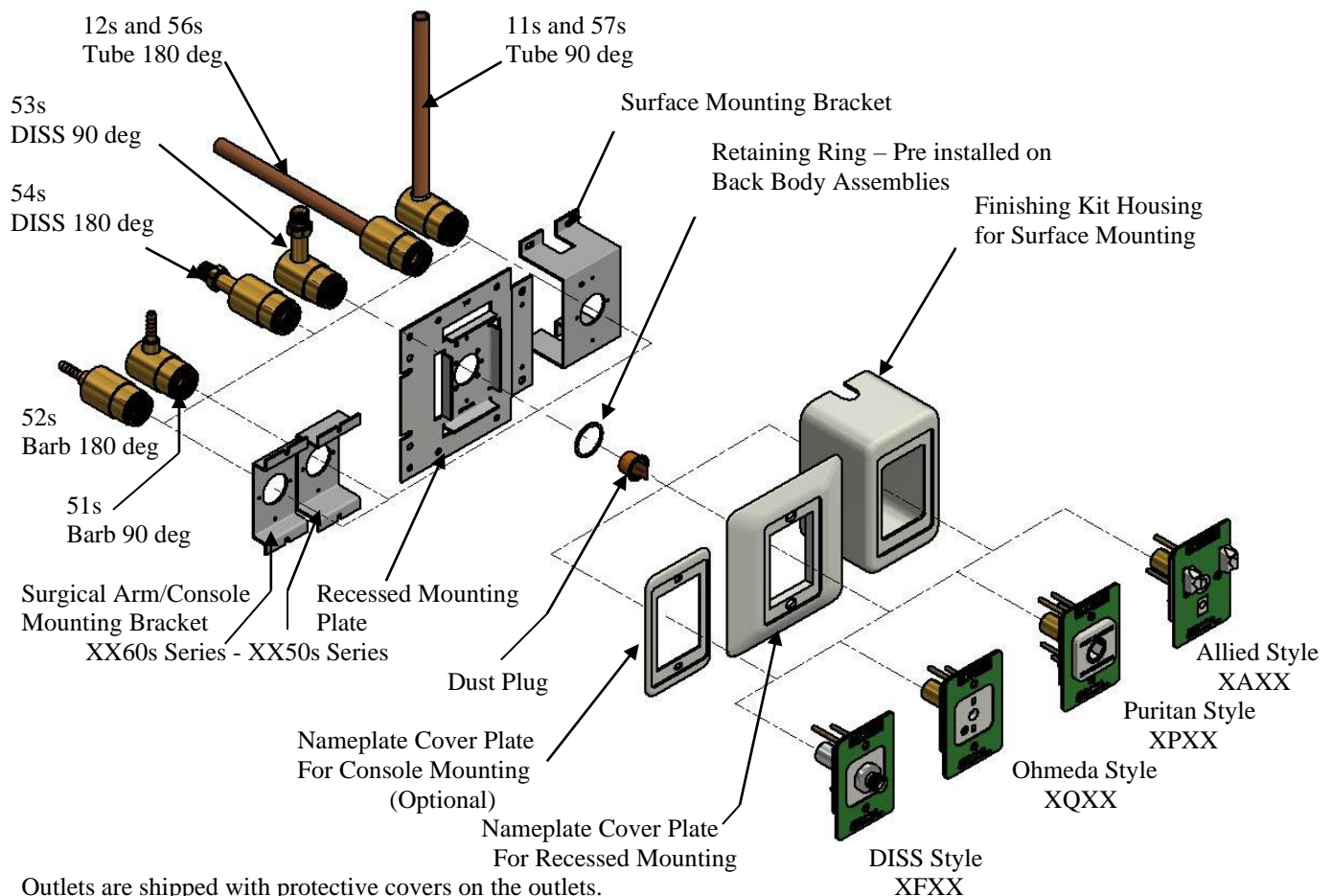

Outlets are shipped with protective covers on the outlets.

Do not remove covers until necessary for trim plate and cover plate assembly to prevent debris from contaminating the outlet.

Refer to reverse side for detailed instructions

**Tri-Tech Common Back Outlet Installation Instructions**

**Important:** Tri-Tech Medical outlets have been pre-tested to the requirements for manufactured assemblies in accordance with National Fire Protection Association (NFPA) pamphlet 99. Outlets should be installed and tested in accordance with recommendations specified in National Fire Protection Association (NFPA) pamphlet 99.

**Outlet Installation**

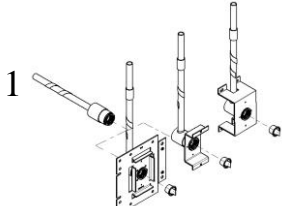

Install the outlet and remove the shipping plug.  
Make sure drop is for proper gas service. Connect the Outlet extension tube, Barb Fitting, or DISS connection to the gas piping system.

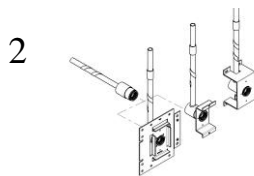
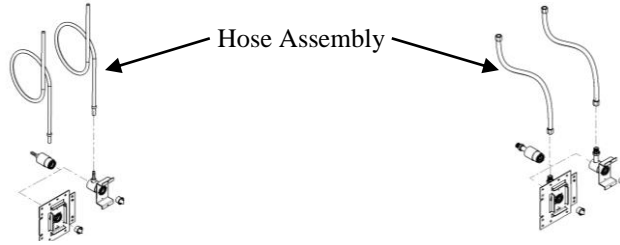

Outlet Extension Tube - Silver Braze joint, **DO NOT USE SOFT SOLDER**. Conduct heat away from the outlet, using a nitrogen purge.  
Barb Fitting - Slide the hose over the Hose Barb and apply a crimp type ferrule to secure the hose.  
DISS Fitting - Secure the hose fitting over the DISS fitting and hand tighten, finish tightening with open-end wrench.

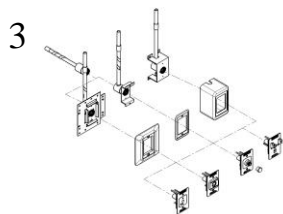
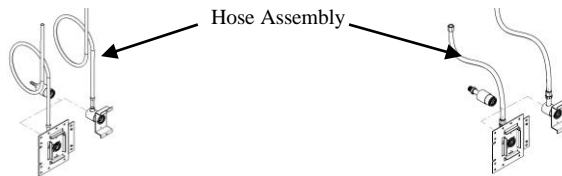

Remove protective caps from outlets. Test outlet for leakage in accordance with NFPA standards.  
Install cover plate, aligning indexing pin with indexing hole in outlet assembly. Install and tighten screws.

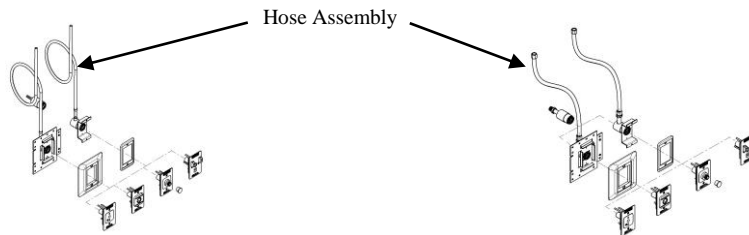

**Tri-Tech Common Back Outlet Installation Instructions**

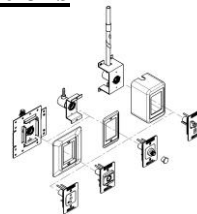
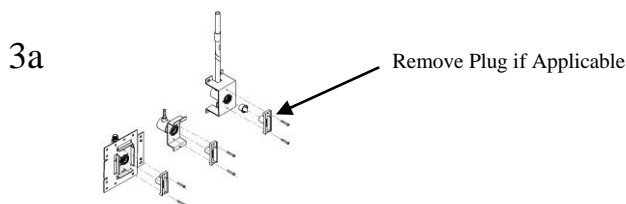

For Medical Vacuum and WAGD outlet Only; (Remove protective caps from outlets if applicable.) Insert the plug and tighten down the mounting screws.  
Test outlet for leakage in accordance with NFPA standards. Install cover plate, aligning indexing pin with indexing hole in outlet assembly. Install and tighten screws. **WARNING:** Do not overtighten finishing kit screws on the XA (Allied) series outlets, this may cause damage or malfunction.

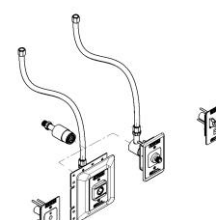
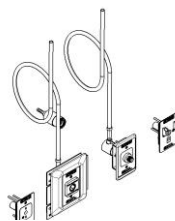
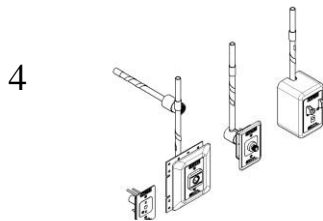

Test outlets for cross connection and any other applicable tests in accordance with NFPA standards. Installation is complete.

If further assistance is required, contact Tri-Tech Medicals technical service department.